

SIEMENS

SINAMICS DCM

Base Drive panel instructions — version 3.0

High-performance drives

3 Parts and service (continued)

Printed circuit boards

Description	Where used US rating 480V	Part number	Recommended spare
Advanced CUD (C98043-A7100-L4)	All Ratings	6RY18030AA050AA1	1
Memory card (C98130-A7100-B1)	All Ratings	6RX18000AS01	1
Connector board (C98043-A7125-L1)	All Ratings	6RY18030GA00	1
Allocation board* (C98043-A7126-L1)	All Ratings	6RY18030GA01	1
Power Interface board (2Q Only) (C98043-A7105-L1)	All 2Q Ratings	6RY18030DA01	1
Power Interface board (4Q Only) (C98043-A7105-L4)	All 4Q Ratings	6RY18030DA02	1
Basic Operator Panel BOP20 (A5E00111019)	All Ratings	6SL30550AA004BA0	1
Field Supply/Power Section +RC (4Q Only) (C98043-A7111-L1)	15 Amp	6RY18030CA01	1
Field Supply/Power Section +RC (4Q Only) (C98043-A7111-L2)	30 Amp	6RY18030CA02	1
Field Supply board (2Q and 4Q) (C98043-A7120-L6)	60 to 125 Amp	6RY18030CA03	1
Field Supply board (2Q and 4Q) (C98043-A7115-L12)	210 to 850 Amp	6RY18030CA04	1
Field Supply board (2Q and 4Q) (C98043-A7116-L1)	1200 Amp	6RY18030CA05	1
Snubber board (RC) (C98 043-A7007-L4)	60 to 280 Amp	6RY18030FA05	1
Snubber board (RC) (C98043-A7011-L6)	450 and 600 Amp	6RY17030FA10	1
Snubber boards (RC) (C98043-A7011-L1)	850 Amp and 1200 Amp	6RY17030FA06	2
Fuse for Power Supply, 1 amp F1, F2 Mounted on Power Interface board	All Ratings	6RY17020BA00	2
Heat Sink Temperature Sensor (C98 043-A7010-L2)	All Ratings	6RY18060AB00	1

*When ordering please indicate the units order No. (MLFB) and Serial Number.

Terminal locations advanced and standard control unit DC (CUD)

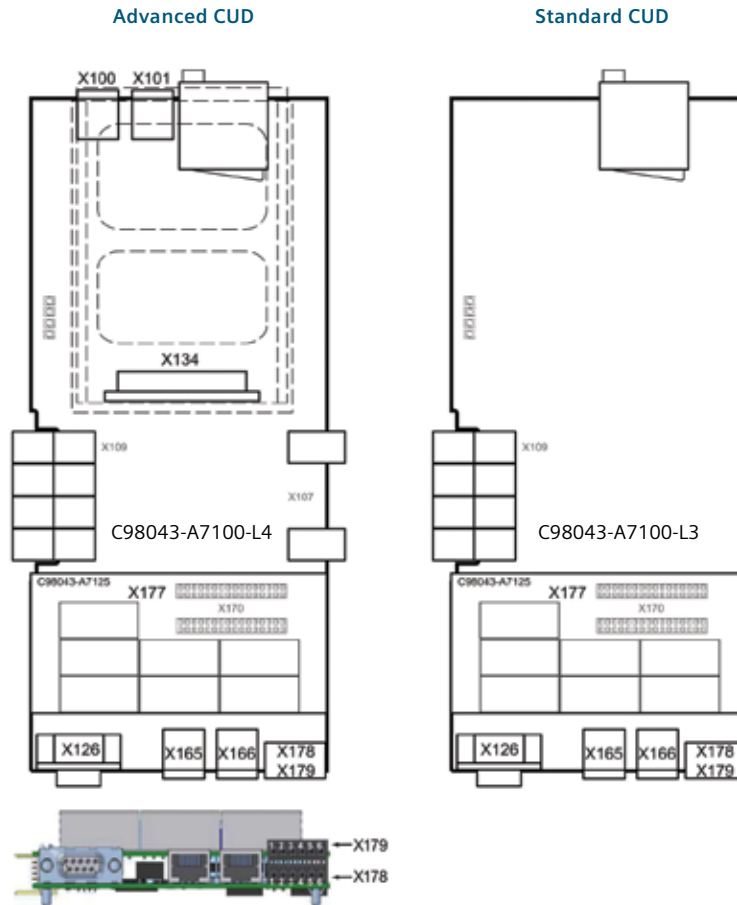

Figure 6-38 A7100 terminal/connector arrangement

Module C98043-A7100 — Control unit (CUD)
 C98043-A7100-L3 = Standard CUD
 C98043-A7100-L4 = Advanced CUD
 (shown with connector board C98043-A7125 installed)